

	E T L	EQUIPAGGIAMENTI TECNICI LAVAGGIO	ATTACCO RAPIDO A GHIERA QUICK COUPLING WITH NUT <b>AR1</b> M21x1.5	(I) (GB)	<b>5</b> 01
					16/04/14

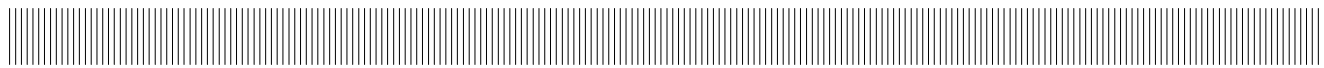

**SPECIFICHE TECNICHE**  
**SPECIFICATIONS**

- PRESSIONE NOMINALE RATED PRESSURE	250 bar – 25 MPa (3650 psi)
- PRESSIONE CONSENTITA PERMISSIBLE PRESSURE	280 bar – 28 MPa (4050 psi)
- PORTATA MASSIMA MAX FLOW RATE	40 l/min (10.5 USG p.m.)
- TEMPERATURA MASSIMA MAX WORKING TEMPERATURE	160° C (320 °F)
- MATERIALE MATERIAL	GIRELLO IN PLASTICA ANTIURTO E GUARNIZIONI OR IN VITON. BODY IN SHOCKPROOF PLASTIC AND VITON O-RING

**MISURE D'INGOMBRO**  
**OVERALL DIMENSIONS**

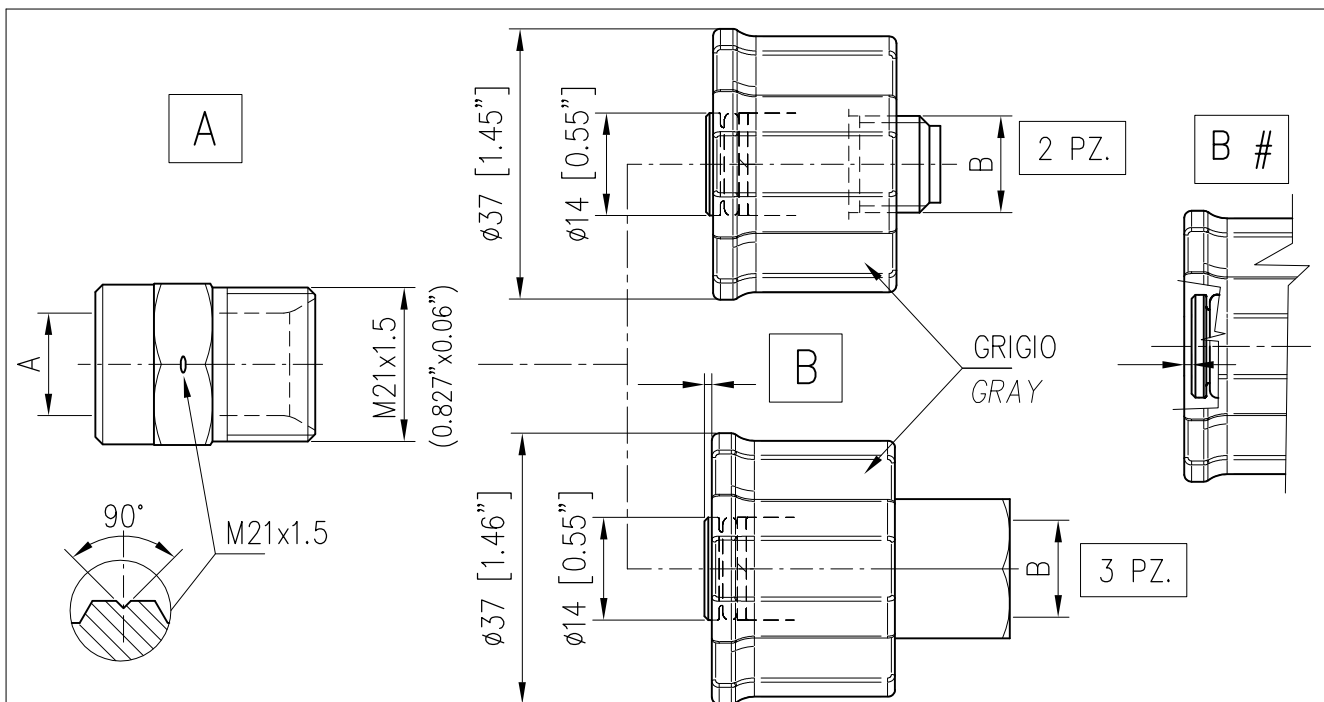

CODICE CODE	A
26.0041.31	M22x1.5 – Di 14
26.0042.31	G1/8M
26.0043.31	G1/8F
26.0044.31	G1/4M
26.0045.31	G1/4F
26.0046.31	G3/8M
26.0047.31	G3/8F
26.0048.31	G1/2M
26.0049.31	G1/2F
26.0062.31	M21x1.5 – Di 14
26.0063.31	M16x1.5 ERMETO
26.0065.31	M18x1.5 ERMETO

	CODICE CODE	B
2 PZ.	26.0155.30	G1/4M
	26.0270.05	G1/8F
	26.0270.20	G1/4F
	26.0270.30	G1/4M
3 PZ.	26.0270.40	G3/8F
	26.0270.50	G3/8M
	26.0270.70	G1/2M

	CODICE CODE	B # PERNO GIREVOLE ROTATING PIN
	26.0270.41	G3/8F